

PIN Layout

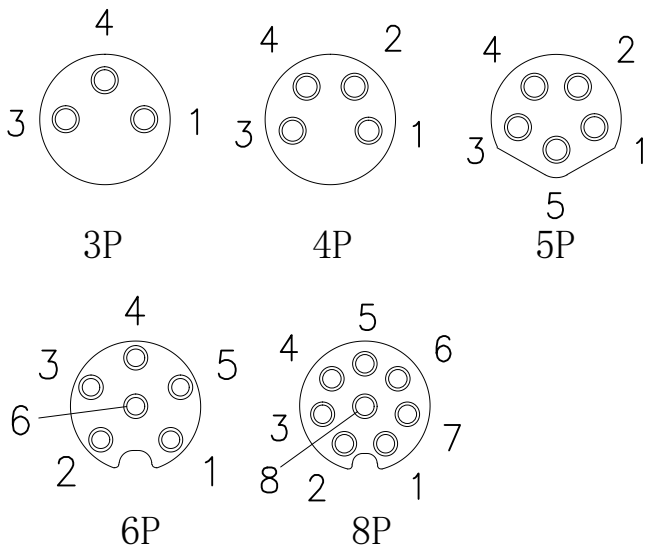

PCB LAYOUT

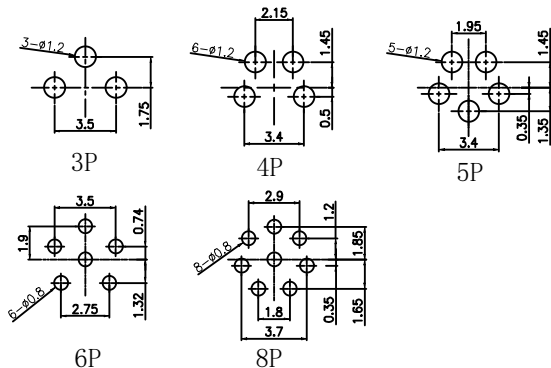

Product NO.

RHT-634-3234

ISSUE	DESCRIPTION	DWN	DATE	APPROVEN
R1.0	First issue	Ding	2022.06.01	JIM.KING

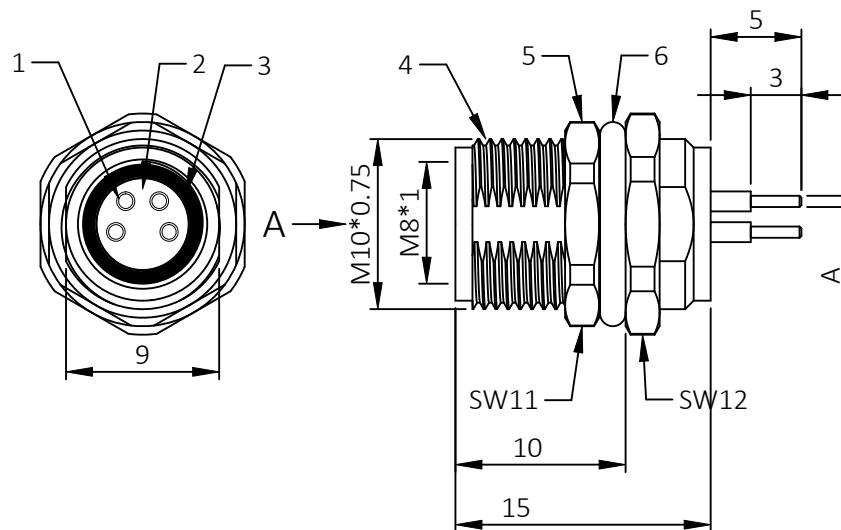

A:
 3P, 4P, 5P: $\phi 1\text{mm}$
 6P, 8P: $\phi 0.6\text{mm}$

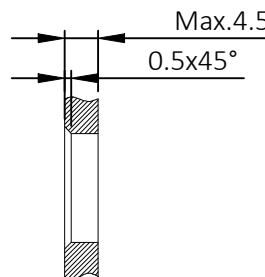

Recommended
Panel cut-out

- Technical specifications:
- Rated voltage/current:
 3/4pin: 60V/3A
 5pin: 30V/3A
 6/8pin: 30V/1.5A
 - Degree of protection: IP67
 - Temperature range: $-25^{\circ}\text{C} \sim +80^{\circ}\text{C}$
 - Mating cycles: >500

6	O-Ring	NBR, Black	1
5	Nut	Brass; Nickel plated	1
4	Body	M8 female Shell, Brass; Nickel plated	1
3	O-Ring	FKM, green	1
2	Housing	M8 female A-Coding, PA66, Black	1
1	Pin	Brass; Gold-plated	3-8
No.	PART NAME	DESCRIPTION	Q'TY

-TOLERANCES-
UNLESS OTHERWISE
SPECIFIED



RENHOTEC GROUP

UNLESS OTHERWISE SPECIFIED
TOLERANCES FOR MILLIMETERS ARE:
 0.5 - 8mm $\pm 0.20\text{mm}$
 8 - 30mm $\pm 0.25\text{mm}$
 30 - 120mm $\pm 0.30\text{mm}$

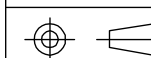

PART DESCRIPTION:
M8 female Connector ,PCB type

Appr: JIM.KING

P/N: RHT-634-3234

Check:

Date	Scale	Unit	Type	Page
2022.12.01	Free	MM	Z	1/1

Draw: DING